

# ET-575 SERIES



## SMD Power Inductors



- Magnetically shielded
- High current—up to 8.2 Adc saturation current
- Very low DCR
- Low cost for general purposes application
- Custom versions available upon request
- Tape & Reel package

### Mechanical Dimensions:

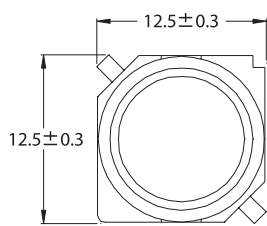

(TOP VIEW)

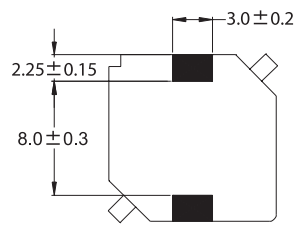
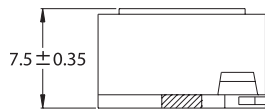

(BOTTOM VIEW)

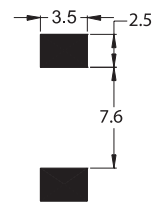

RECOMMENDED PCB LAYOUT

UNIT:mm

Part Number	Inductance <sup>1</sup> (μH)	DCR (mΩ max.)	Isat <sup>2</sup> (Adc)
ET - 575 - 1R2	1.2	8.3	8.2
ET - 575 - 2R7	2.7	11.3	7.0
ET - 575 - 3R9	3.9	12.5	6.7
ET - 575 - 5R6	5.6	15.6	6.3
ET - 575 - 6R8	6.8	17.5	5.9
ET - 575 - 100	10	22.1	5.4
ET - 575 - 150	15	30.5	4.7
ET - 575 - 220	22	38.0	4.0
ET - 575 - 330	33	61.7	3.2
ET - 575 - 470	47	72.6	2.7
ET - 575 - 680	68	109	2.0
ET - 575 - 101	100	160	1.9
ET - 575 - 151	150	255	1.5
ET - 575 - 221	220	375	1.3

1. Inductance tested at 100kHz, 0.1Vrms, 0Adc.  
Tolerance 1.2 μH~6.8 μH ±30% 10.0 μH~220.0 μH ±20%
2. Inductance drop = 10% typ. at rated Isat.
3. ΔT = 45°C rise typ.
4. Operating temperature range -40°C to + 85°C.
5. Electrical specifications at 25°C.