

# ET-568 SERIES



## SMD Power Inductors

ET-568 SERIES



- Magnetically shielded
- Low profile—only 7.0 x 7.0 x 3.0 mm (high)
- Low DCR
- Low cost for general purposes application
- Custom versions available upon request
- Tape & Reel package

### Mechanical Dimensions:

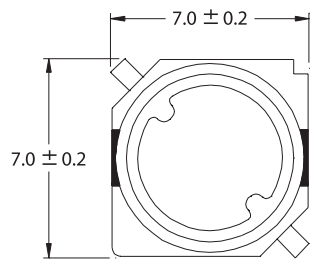

(TOP VIEW)

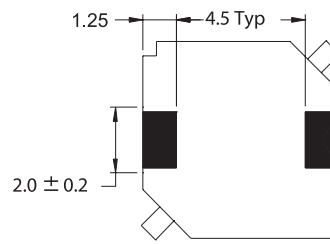

(BOTTOM VIEW)

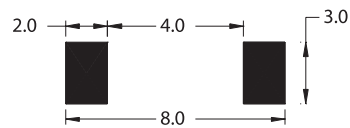

RECOMMENDED PCB LAYOUT

UNIT:mm

Part Number	Inductance <sup>1</sup> ( $\mu$ H $\pm$ 20%)	DCR (m $\Omega$ max.)	Isat <sup>2</sup> (Adc)
ET - 568 - 3R3	3.3	50	1.6
ET - 568 - 4R7	4.7	60	1.5
ET - 568 - 6R8	6.8	80	1.3
ET - 568 - 100	10	110	1.1
ET - 568 - 150	15	165	0.88
ET - 568 - 220	22	230	0.75
ET - 568 - 330	33	315	0.65
ET - 568 - 470	47	470	0.54

1. Inductance tested at 100kHz, 0.1Vrms, 0Adc.
2. Inductance drop = 10% typ. at rated Isat.
3.  $\Delta$ T = 45°C rise typ.
4. Operating temperature range -40°C to + 85°C.
5. Electrical specifications at 25°C.