

ET-565 SERIES



SMD Power Inductors



- Magnetically shielded
- Large foot print design for excellent soldering
- Low cost for wide application
- Custom versions available upon request
- Tape & Reel package

Mechanical Dimensions:

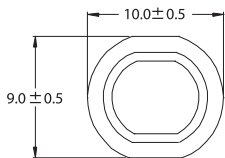

(TOP VIEW)

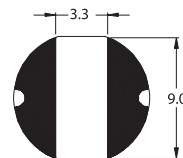
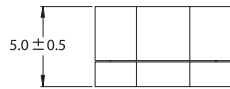

(BOTTOM VIEW)

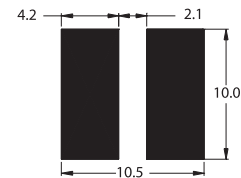

RECOMMENDED PCB LAYOUT

UNIT:mm

Part Number	Inductance ¹ (μ H \pm 20%)	DCR (Ω max.)	Isat ² (Adc)
ET - 565 - 100	10	0.06	2.06
ET - 565 - 120	12	0.07	1.94
ET - 565 - 150	15	0.08	1.72
ET - 565 - 180	18	0.09	1.58
ET - 565 - 220	22	0.10	1.42
ET - 565 - 270	27	0.11	1.32
ET - 565 - 330	33	0.12	1.16
ET - 565 - 390	39	0.13	1.10
ET - 565 - 470	47	0.15	1.00
ET - 565 - 560	56	0.19	0.93
ET - 565 - 680	68	0.21	0.85
ET - 565 - 820	82	0.28	0.79
ET - 565 - 101	100	0.34	0.72
ET - 565 - 121	120	0.37	0.63
ET - 565 - 151	150	0.51	0.55
ET - 565 - 181	180	0.57	0.50
ET - 565 - 221	220	0.78	0.47
ET - 565 - 271	270	0.87	0.41
ET - 565 - 331	330	1.20	0.37
ET - 565 - 391	390	1.34	0.35
ET - 565 - 471	470	1.50	0.33

1. Inductance tested at 100kHz, 0.1Vrms, 0Adc.
2. Inductance drop = 20% typ. at rated Isat.
3. Δ T = 45°C rise typ.
4. Operating temperature range -40°C to + 85°C.
5. Electrical specifications at 25°C.