

ET-554 SERIES



SMD Power Inductors

ET-554 SERIES



- Magnetically shielded
- Very high current—up to 10 Adc saturation current
- Very low DCR
- Low cost for wide application
- Custom versions available upon request
- Tape & Reel package

Mechanical Dimensions:

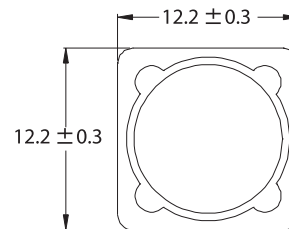

(TOP VIEW)

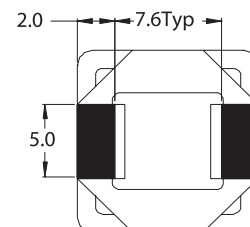
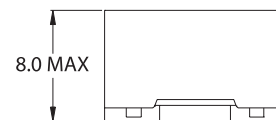

(BOTTOM VIEW)

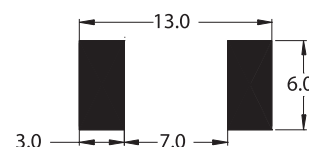

RECOMMENDED PCB LAYOUT

Part Number	Inductance ¹ (μ H)	DCR (m Ω max.)	Isat ² (Adc)
ET - 554 - 1R2	1.2	7	10
ET - 554 - 1R8	1.8	8	9.5
ET - 554 - 2R4	2.4	12	9.0
ET - 554 - 3R5	3.5	14	8.2
ET - 554 - 4R7	4.7	16	7.0
ET - 554 - 6R1	6.1	18	6.8
ET - 554 - 6R8	6.8	19	6.6
ET - 554 - 8R2	8.2	20	5.9
ET - 554 - 100	10	22	5.4
ET - 554 - 120	12	25	4.9
ET - 554 - 150	15	27	4.5
ET - 554 - 180	18	40	3.9
ET - 554 - 220	22	44	3.6
ET - 554 - 270	27	46	3.4
ET - 554 - 330	33	65	3.0
ET - 554 - 390	39	73	2.8
ET - 554 - 470	47	100	2.5
ET - 554 - 560	56	110	2.3
ET - 554 - 680	68	140	2.1
ET - 554 - 820	82	160	1.95
ET - 554 - 101	100	220	1.7
ET - 554 - 121	120	250	1.6
ET - 554 - 151	150	280	1.4
ET - 554 - 181	180	350	1.3
ET - 554 - 221	220	390	1.2
ET - 554 - 271	270	560	1.0
ET - 554 - 331	330	640	0.95
ET - 554 - 391	390	700	0.88
ET - 554 - 471	470	980	0.79
ET - 554 - 561	560	1070	0.73
ET - 554 - 681	680	1460	0.67
ET - 554 - 821	820	1640	0.60
ET - 554 - 102	1000	1820	0.55

- Inductance tested at 100kHz, 0.1Vrms, 0Adc.
Tolerance : 1.2 μ H~8.2 μ H +40%/-20% 10 μ H~1000 μ H \pm 20%
- Inductance drop = 25% typ. at rated Isat.
- Δ T = 45°C rise typ.
- Operating temperature range -40°C to + 85°C.
- Electrical specifications at 25°C.

UNIT:mm