

# ET-548 SERIES



## SMD Power Inductors



- High current—up to 2.4 Adc saturation current
- Very low DCR
- Low cost for wide application
- Custom versions available upon request
- Tape & Reel package

### Mechanical Dimensions:

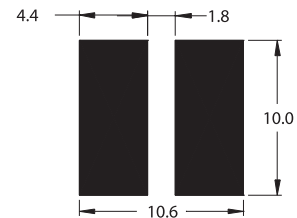
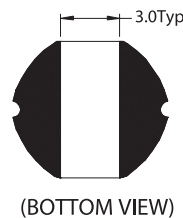
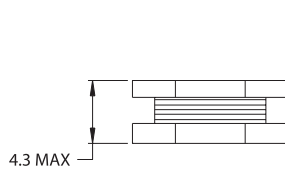
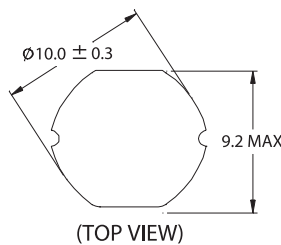

RECOMMENDED PCB LAYOUT

UNIT:mm

Part Number	Inductance <sup>1</sup> ( $\mu$ H $\pm$ 10%)	DCR ( $\Omega$ max.)	Isat <sup>2</sup> (Adc)
ET - 548 - 100	10	0.053	2.4
ET - 548 - 120	12	0.061	2.2
ET - 548 - 150	15	0.070	1.9
ET - 548 - 180	18	0.081	1.8
ET - 548 - 220	22	0.088	1.6
ET - 548 - 270	27	0.100	1.5
ET - 548 - 330	33	0.120	1.3
ET - 548 - 390	39	0.151	1.2
ET - 548 - 470	47	0.170	1.1
ET - 548 - 560	56	0.199	1.0
ET - 548 - 680	68	0.223	0.91
ET - 548 - 820	82	0.252	0.85
ET - 548 - 101	100	0.344	0.74
ET - 548 - 121	120	0.396	0.69
ET - 548 - 151	150	0.544	0.61
ET - 548 - 181	180	0.621	0.56
ET - 548 - 221	220	0.721	0.53
ET - 548 - 271	270	0.949	0.45
ET - 548 - 331	330	1.100	0.42
ET - 548 - 391	390	1.245	0.38
ET - 548 - 471	470	1.526	0.35
ET - 548 - 561	560	1.904	0.32

1. Inductance tested at 100kHz, .1Vrms, Adc.
2. Inductance drop = 10% typ. at rated Isat.
3.  $\Delta$ T = 45°C rise typ.
4. Operating temperature range -40°C to + 85°C.
5. Electrical specifications at 25°C.