

ET-25100 SERIES

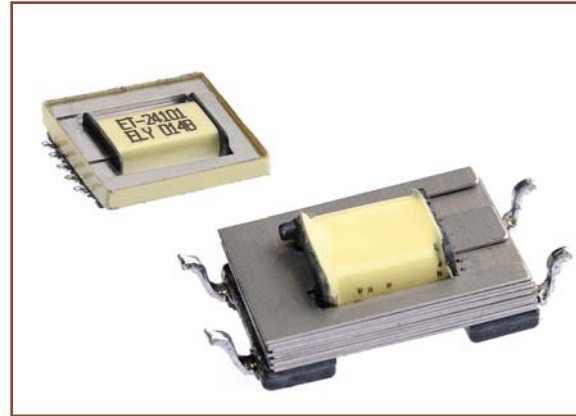

Surface Mount / PCMCIA Transformers

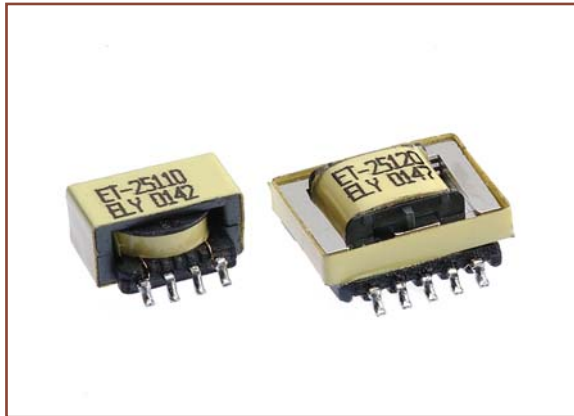

ET-25100 SERIES

Mechanical Dimensions:

Type A

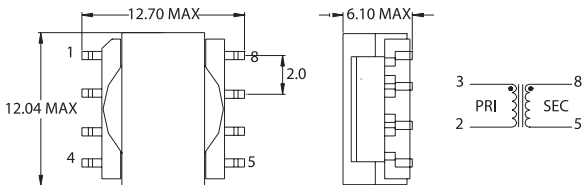

Type B

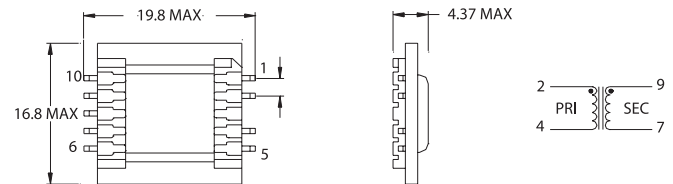

Type C

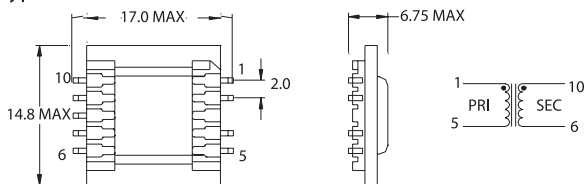

Type D

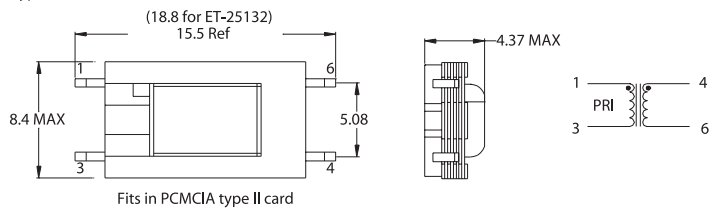

UNIT:mm

Specifications	ET-25101	ET-25102	ET-25110	ET-25120	ET-25130	ET-25132	ET-25133	Unit
Suitable for modem speed up to:	V .32 bis	V .32 bis	V.29	V.32bis	V.32 bis	V.34	V.34	-----
Reflects 600 ohms at PRI with R load =	294	294	487	332	301	290	300	ohms
D.C. Resistance,20°C, ±10%,PRI	156	155	67	132	150	141	140	ohms
D.C. Resistance,20°C, ±10%,SEC	145	159	85	132	150	171	170	ohms
Frequency Response,300 to 3500 Hz	±0.25	±0.25	±0.5	±0.25	±0.15	±0.10	±0.10	dB
Insertion Loss at 1 KHz,20°C	3.15±0.25	3.30±0.25	1.5 max	2.6±0.35	3.3±0.25	3.3±0.25	3.15±0.35	dB
Return Loss vs.600 ohms at 1 KHz	25 min	20 min	17 typ.	25 min	25 min	30 min	25 min	dB
Dielectric Test PRI-SEC	1250	1650	1250	1250	1250	1250	1250	V AC
Direct Current PRI, maximum	none	none	none	none	none	none	none	mA DC
Turns Ratio (PRI:SEC), ±2%	1 : 1	1 : 1	1 : 1	1 : 1	1 : 1	1 : 1	1 : 1	-----
Longitudinal Balance,60 to1000 Hz,min.	60	60	60	60	60	60	60	dB
Longitudinal Balance,1000 to 4000 Hz,min.	40	40	40	40	40	40	40	dB
Total Harmonic Dist.,600 Hz,-10 dBm	-76 max	-76 max	-60 typ.	-76 max	-76 max	-85 max	-90 max	dB
Type	B	B	A	C	D	D	D	