

Low Profile Power Transformers



- Primary 115/230V 50/60Hz input, secondary single or Dual output DC Supplies Isolated
- Split bobbin for low leakage application, 1500V hipot
- Low capacity coupling minimizes line noise and false triggering

Part Number	Size (VA)	SECONDARY RATING (RMS)	
		Series	Parallel
EPL - 10 - 250	2.5	10V C.T. @ 250mA	5V @ 500mA
EPL - 10 - 600	6	10V C.T. @ 600mA	5V @ 1.2A
EPL - 10 - 1200	12	10V C.T. @ 1200mA	5V @ 2.4A
EPL - 12 - 200	2.5	12.6V C.T. @ 200mA	6.3V @ 400mA
EPL - 12 - 450	6	12.6V C.T. @ 450mA	6.3V @ 900mA
EPL - 12 - 900	12	12.6V C.T. @ 900mA	6.3V @ 1.8A
EPL - 16 - 150	2.5	16V C.T. @ 150mA	8V @ 300mA
EPL - 16 - 350	6	16V C.T. @ 350mA	8V @ 700mA
EPL - 16 - 700	12	16V C.T. @ 700mA	8V @ 1.4A
EPL - 20 - 125	2.5	20V C.T. @ 125mA	10V @ 250mA
EPL - 20 - 300	6	20V C.T. @ 300mA	10V @ 600mA
EPL - 20 - 600	12	20V C.T. @ 600mA	10V @ 1.2A
EPL - 24 - 100	2.5	24V C.T. @ 100mA	12V @ 200mA
EPL - 24 - 250	6	24V C.T. @ 250mA	12V @ 500mA
EPL - 24 - 500	12	24V C.T. @ 500mA	12V @ 1A
EPL - 30 - 85	2.5	30V C.T. @ 85mA	15V @ 170mA
EPL - 30 - 200	6	30V C.T. @ 200mA	15V @ 400mA
EPL - 30 - 400	12	30V C.T. @ 400mA	15V @ 800mA
EPL - 34 - 75	2.5	34V C.T. @ 75mA	17V @ 150mA
EPL - 34 - 170	6	34V C.T. @ 170mA	17V @ 340mA
EPL - 34 - 340	12	34V C.T. @ 340mA	17V @ 680mA
EPL - 40 - 60	2.5	40V C.T. @ 60mA	20V @ 120mA
EPL - 40 - 150	6	40V C.T. @ 150mA	20V @ 300mA
EPL - 40 - 300	12	40V C.T. @ 300mA	20V @ 600mA
EPL - 56 - 45	2.5	56V C.T. @ 45mA	28V @ 90mA
EPL - 56 - 100	6	56V C.T. @ 100mA	28V @ 200mA
EPL - 56 - 200	12	56V C.T. @ 200mA	28V @ 400mA
EPL - 88 - 28	2.5	88V C.T. @ 28mA	44V @ 56mA
EPL - 88 - 65	6	88V C.T. @ 65mA	44V @ 130mA
EPL - 88 - 130	12	88V C.T. @ 130mA	44V @ 260mA
EPL - 120 - 20	2.5	120V C.T. @ 20mA	60V @ 40mA
EPL - 120 - 50	6	120V C.T. @ 50mA	60V @ 100mA
EPL - 120 - 100	12	120V C.T. @ 100mA	60V @ 200mA
EPL - 230 - 10	2.5	230V C.T. @ 10mA	115V @ 20mA
EPL - 230 - 25	6	230V C.T. @ 25mA	115V @ 50mA
EPL - 230 - 50	12	230V C.T. @ 50mA	115V @ 100mA

Mechanical Dimensions:

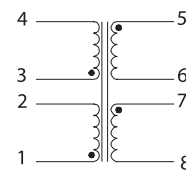
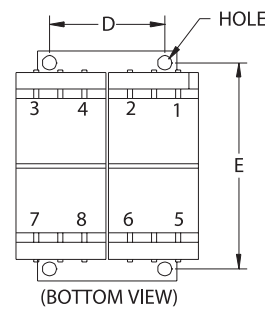
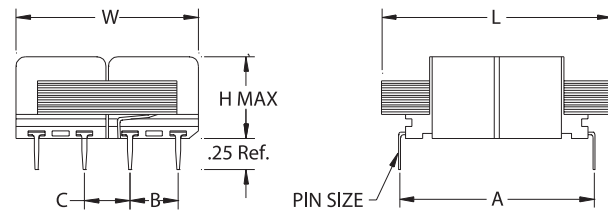

UNIT: INCHES

- 1.Regulation of size 2.5 and 6 is 30% , i.e., no load-secondary voltage is 30% higher than that of full load.
- 2.Regulation of size 12 is 20%.

SIZE (VA)	L ±0.04	W ±0.04	H ±0.04	A ±0.02	B ±0.012	C ±0.012	D ±0.02	E ±0.02	PIN SIZE ±0.01	HOLE ±0.02
2.5	1.875	1.562	0.650	1.600	0.375	0.375	0.874	1.624	0.040x0.0197	0.126
6	1.875	1.562	0.850	1.600	0.375	0.375	0.874	1.624	0.040x0.0197	0.126
12	2.520	2.000	1.065	2.000	0.500	0.500	0.984	2.008	0.040x0.0197	0.165

Low Profile Power Transformers



- 115/230V 50/60Hz high power usage
- Rugged Plug-IN pin

Mechanical Dimensions:

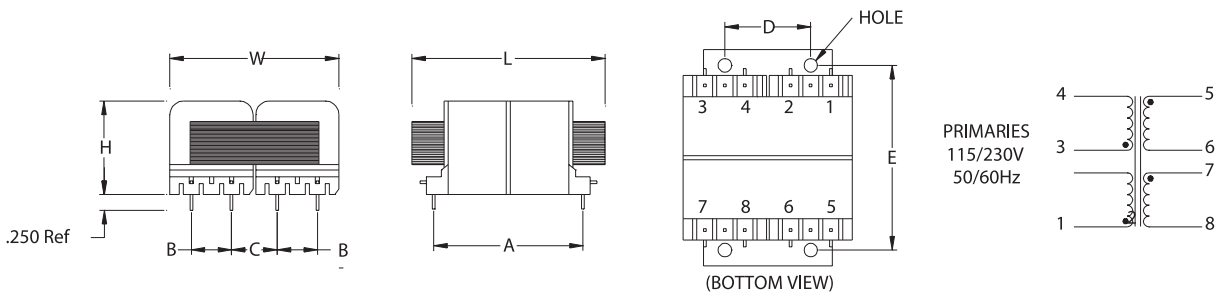

UNIT: INCHES

Part Number	Size (VA)	SECONDARY RATING (RMS)	
		Series	Parallel
EPL - 10 - 2400	24	10V C.T. @ 2.40A	5V @ 4.80A
EPL - 10 - 4800	48	10V C.T. @ 4.80A	5V @ 9.60A
EPL - 12 - 1900	24	12.6V C.T. @ 1.90A	6.3V @ 3.80A
EPL - 12 - 3800	48	12.6V C.T. @ 3.80A	6.3V @ 7.60A
EPL - 16 - 1500	24	16V C.T. @ 1.50A	8V @ 3.00A
EPL - 16 - 3000	48	16V C.T. @ 3.00A	8V @ 6.00A
EPL - 20 - 1200	24	20V C.T. @ 1.20A	10V @ 2.40A
EPL - 20 - 2400	48	20V C.T. @ 2.40A	10V @ 4.80A
EPL - 24 - 1000	24	24V C.T. @ 1.00A	12V @ 2.00A
EPL - 24 - 2000	48	24V C.T. @ 2.00A	12V @ 4.00A
EPL - 30 - 800	24	30V C.T. @ 800mA	15V @ 1.60A
EPL - 30 - 1600	48	30V C.T. @ 1.60A	15V @ 3.20A
EPL - 34 - 700	24	34V C.T. @ 700mA	17V @ 1.40A
EPL - 34 - 1400	48	34V C.T. @ 1.40A	17V @ 2.80A
EPL - 40 - 600	24	40V C.T. @ 600mA	20V @ 1.20A
EPL - 40 - 1200	48	40V C.T. @ 1.20A	20V @ 2.40A
EPL - 56 - 425	24	56V C.T. @ 425mA	28V @ 850mA
EPL - 56 - 850	48	56V C.T. @ 850mA	28V @ 1.70A

SIZE (VA)	L ±0.02	W ±0.04	H ±0.04	A ±0.02	B ±0.012	C ±0.012	D ±0.02	E ±0.02	PIN SIZE ±0.01	HOLE ±0.02
24	2.87	2.25	1.250	1.900	.600	.530	1.315	2.42	SQ 0.04	0.150
48	3.12	2.50	1.375	2.180	.600	.660	1.260	2.62	SQ 0.04	0.197